

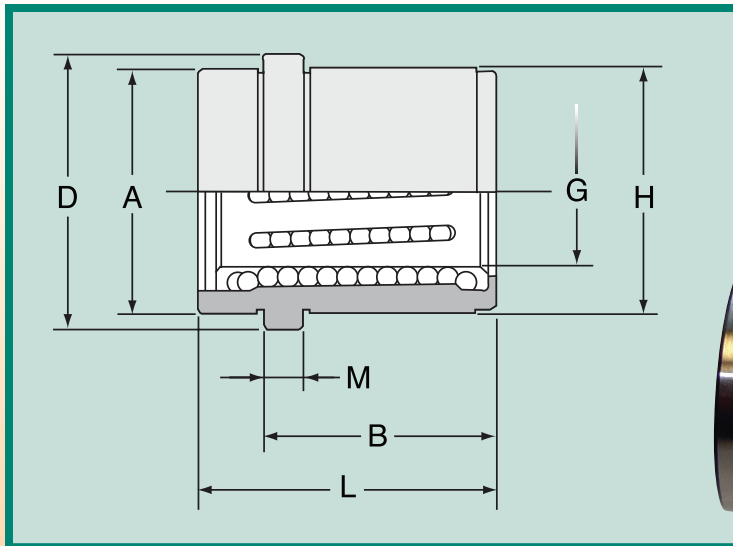

Ball Guided Ejector Bushings

Bolex® Inch Series



Nom. I.D.	G	H +.0005 -.0000	A +.000 -.001	D +.000 -.030	L +.000 -.030	B +.000 -.030	M +.000 -.005	Catalog Number
3/4	.751	1.2505	1.2490	1.427	1.50	1.00	.187	BGEB0750
7/8	.876	1.3755	1.3740	1.552	1.75	1.12	.187	BGEB0875
1"	1.001	1.6255	1.6240	1.802	1.75	1.12	.187	BGEB1000
1-1/4	1.251	2.0005	1.9990	2.177	1.75	1.12	.187	BGEB1250
1-1/2	1.501	2.5005	2.4990	2.687	2.25	1.62	.187	BGEB1500

- Materials: Special steel bush. Bronze cage with high resistance to wear.
- High-precision balls.
- Hardness: 60-62 HRC.
- Max Operating temp: 110-125C°.

Material: Special roll steel bush casing, hardened & ground which holds fixed inside a high-resistant bronze cage for guiding the balls running along the cage. The unique feature of these bushings is that the balls do not run aligned, but at a slight angle thus enlarging the contact area and enabling greater load capacity. This system allows the precision balls to circulate endlessly.

Typically for use in the ejector system when a "friction free" application is required. Use DMS "Press Fit" Leader pins with these in the guided ejector system.

Fitting: Ensure that the leader pin holes in the clamp plate and the bores in the ejector set are square and in line. It is recommended to mount at least two units.

Lubrication: The bushings are supplied oiled and must be lubricated when necessary. Proper lubrication and maintenance are a must. The channels that the balls run along must be free and clear of ANY particles, thus the removal of all impurities is essential.

It is recommended to use oils within the range of ISO viscosities from ISO VG 64 to 100.

A complete range of metric ejector, shoulder and straight bushings are also available. Please visit www.bolexp.com or call DMS for further information.

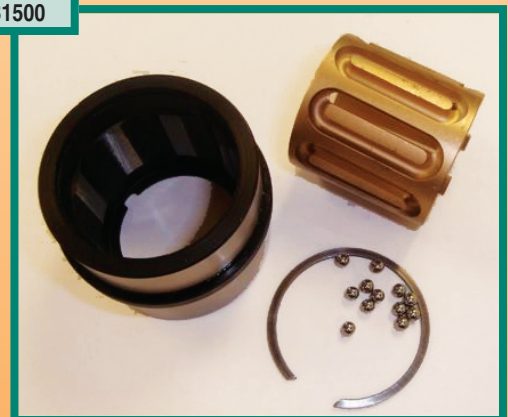

Exploded View