

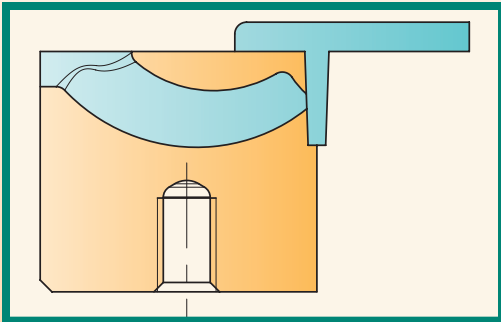

# SGC Cashew Gate Inserts

## Side Gate Contourable

- Curved tunnel permits getting deep inside the part
- Integrated dead-end recess reduces loss of pressure and shear stress
- Highly wear-resistant hot working steel M2 (1.3343) – 54+2 HRC

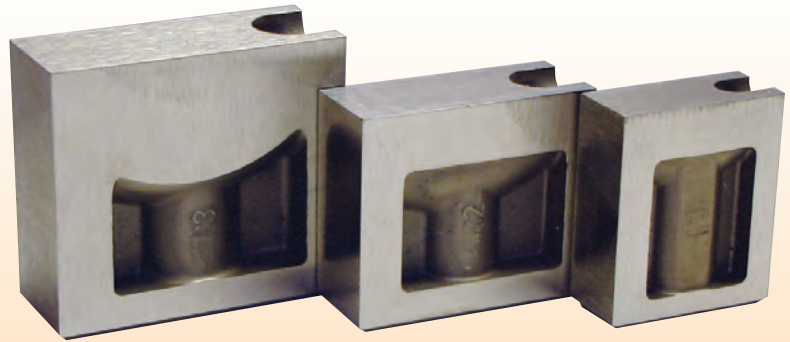

**SGC-XS / SGC-S Mounting Possibilities**

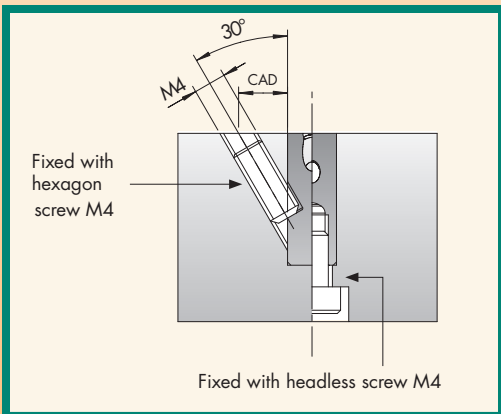

### SGC

	SGC-XS	SGC-S	SGC-1	SGC-2	SGC-3
<b>GATE POINT</b>	0,4 - 0,8	0,4 - 1,0	0,6 - 1,4	0,8 - 2,1	~ Ø 1,1 -3,3
<b>RUNNER</b>	2,5	2,5	4	6	8
<b>MAXIMUM SHOT WEIGHT</b>					
<b>NV</b>	12	20	35	250	1000
<b>MV</b>	7	12	25	120	500
<b>HV</b>	5	8	15	90	300

NV = low viscosity / MV = medium viscosity / HV = high viscosity

Cat. No.	b	b1	b2 max.	d3	h	h1 max.	h2	h3	l1	l2	M
<b>SGC-XS</b>	10	5	1.1	2.5	12	0.6	1.9	2.0	5	3.2	4
<b>SGC-S</b>	15	6	2.0	2.5	18	2	3.5	4.0	8	4	4
<b>SGC-1</b>	18	8	1.8	4	22	2	3.5	4.1	9	5.2	5
<b>SGC-2</b>	25	10	2.5	6	22	2.5	4.8	5.7	8	6.5	5
<b>SGC-3</b>	30	12	2.8	8	27	4.5	7.5	8.4	9	7	6



**NEW**

## Retaining Bush For Use With Cashew Gate Inserts

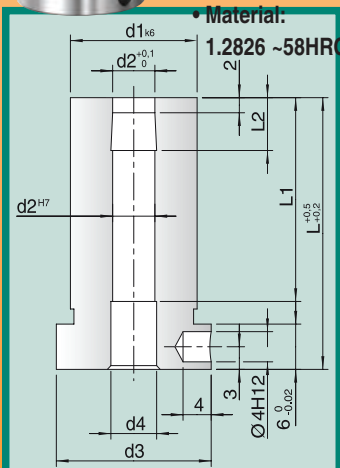

CAT. NO.	L	L1	L2	d1	d2	d3	d4
<b>RB4-36</b>	36	36					
<b>RB4-46</b>	46		7	12	4	16	4.5
<b>RB4-56</b>	56	46					
<b>RB6-36</b>	36	36					
<b>RB6-46</b>	46	46					
<b>RB6-56</b>	56		7	18	6	22	6.5
<b>RB6-66</b>	66	56					
<b>RB8-46</b>	46	46					
<b>RB8-56</b>	56	56	9.5	24	8	28	8.5
<b>RB8-66</b>	66	66					

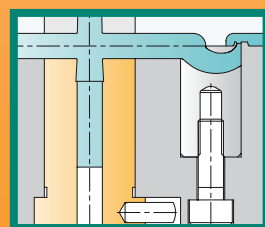
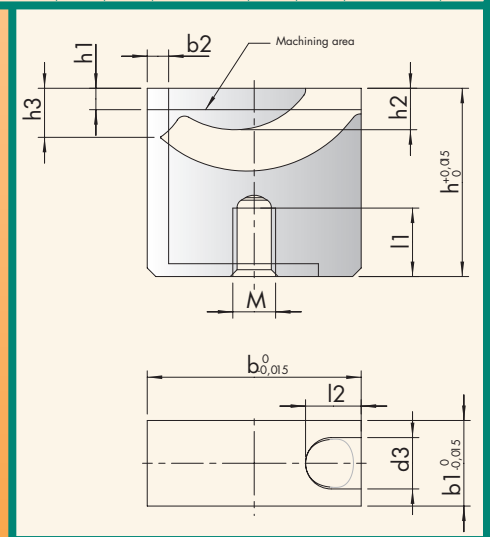

CAD files available at:





# SGC Cashew Gate Inserts

## Side Gate Contourable

### SGC-SX

A (mm)	~O (mm)	b2 (mm)
0.13	0.4	0.9
0.3	0.6	1.0
0.53	0.8	1.1



### SGC-S

A (mm)	~O (mm)	b2 (mm)
0.15	0.4	1.7
0.33	0.6	1.8
0.55	0.8	1.9
0.79	1.0	2.0

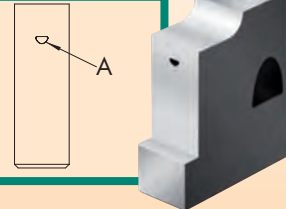

### SGC-1

A (mm)	~O (mm)	b2 (mm)
0.28	0.6	1.4
0.53	0.8	1.5
0.82	1	1.6
1.15	1.2	1.7
1.52	1.4	1.8

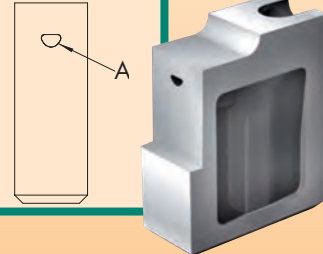

### SGC-2

A (mm)	~O (mm)	b2 (mm)
0.28	0.6	1.7
0.54	0.8	1.8
0.84	1	1.9
1.2	1.2	2
1.57	1.4	2.1
2	1.6	2.2
2.43	1.75	2.3
2.9	1.9	2.4
3.4	2.1	2.5

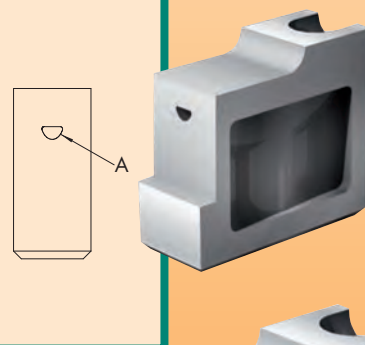

### SGC-3

A (mm)	~O (mm)	b2 (mm)
1	1.1	2
1.75	1.5	2.1
2.56	1.8	2.2
3.43	2.1	2.3
4.35	2.35	2.4
5.32	2.6	2.5
6.33	2.85	2.6
7.38	3	2.7
8.48	3.3	2.8

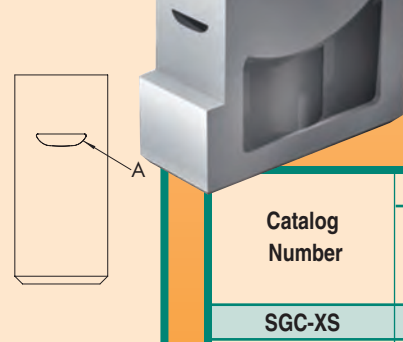

### Thermoplastic elastomers (TPE)

- Low Shore hardness = shorter distance L
- Use centring pin
- Max. hardness 100 Shore A

Standard installation for shallow and medium contour depths

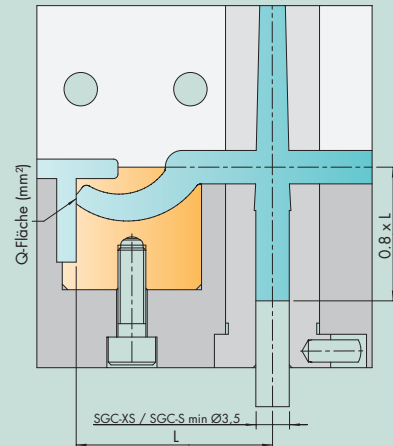

Special installation for deep contours

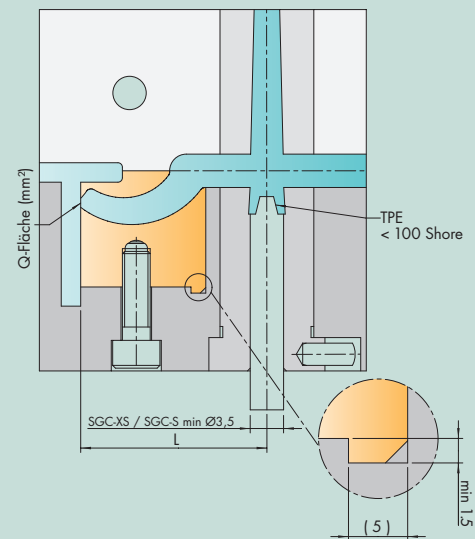

Table for distance L

Catalog Number	Material Type			
	TPE, TPU, etc.	PE, PP, PET etc.	PC/ABS, PA, POM, HI-PC, etc.	PA+GF, PC, SAN, PMMA, etc.
SGC-XS	12-16	13-20	16-23	22-29
SGC-S	16-21	18-25	21-28	27-34
SGC-1	21-26	26-34	31-39	36-45
SGC-2	28-33	31-39	36-44	41-50
SGC3	33-38	38-48	43-53	48-58