

FB2 Series Manifold

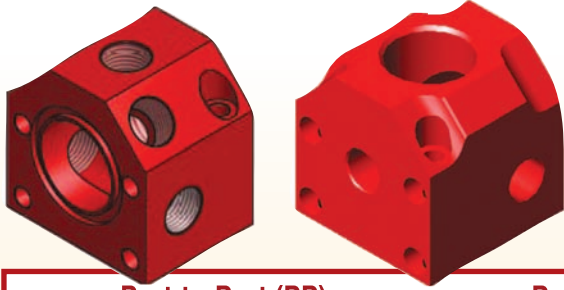

Specifications

Block Size: 2.25" W x 2.25" H
 Material: 6061-T6, Anodized
 Mounting Hole Size: 1/4" SHCS
 Inlet Hole: 1" NPT
 Outlet Hole: 1/4" or 3/8"
 (5) Outlet Holes per Standard Block
 (3) Outlet Holes per 90 Degree Block

Port-to-Port (PP)

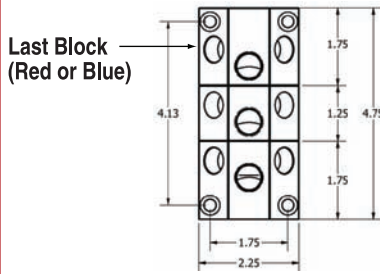

Port-to-Blank (PB)

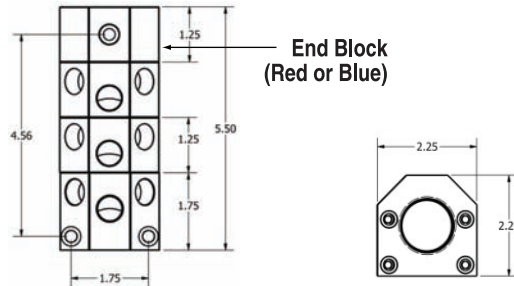

Port-to-Divide (PD)

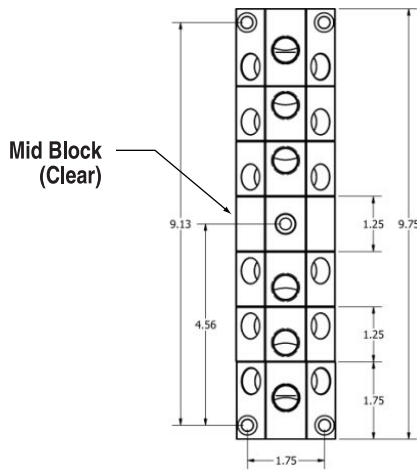

Port-to-Divide



1/4" Outlet

Assembly No.

FB2-1-4-PD
 FB2-2-4-PD
 FB2-3-4-PD
 FB2-4-4-PD
 FB2-5-4-PD

3/8" Outlet

Assembly No.

FB2-1-6-PD
 FB2-2-6-PD
 FB2-3-6-PD
 FB2-4-6-PD
 FB2-5-6-PD

Port-to-Port



1/4" Outlet, Red

Assembly No.

FB2-2-4-R-PP
 FB2-3-4-R-PP
 FB2-4-4-R-PP
 FB2-5-4-R-PP

3/8" Outlet, Red

Assembly No.

FB2-2-6-R-PP
 FB2-3-6-R-PP
 FB2-4-6-R-PP
 FB2-5-6-R-PP

1/4" Outlet, Blue

Assembly No.

FB2-2-4-B-PP
 FB2-3-4-B-PP
 FB2-4-4-B-PP
 FB2-5-4-B-PP

3/8" Outlet, Blue

Assembly No.

FB2-2-6-B-PP
 FB2-3-6-B-PP
 FB2-4-6-B-PP
 FB2-5-6-B-PP

Port-to-Blank



1/4" Outlet, Red

Assembly No.

FB2-1-4-R-PB
 FB2-2-4-R-PB
 FB2-3-4-R-PB
 FB2-4-4-R-PB
 FB2-5-4-R-PB

3/8" Outlet, Red

Assembly No.

FB2-1-6-R-PB
 FB2-2-6-R-PB
 FB2-3-6-R-PB
 FB2-4-6-R-PB
 FB2-5-6-R-PB

1/4" Outlet, Blue

Assembly No.

FB2-1-4-B-PB
 FB2-2-4-B-PB
 FB2-3-4-B-PB
 FB2-4-4-B-PB
 FB2-5-4-B-PB

3/8" Outlet, Blue

Assembly No.

FB2-1-6-B-PB
 FB2-2-6-B-PB
 FB2-3-6-B-PB
 FB2-4-6-B-PB
 FB2-5-6-B-PB

90 Deg First Block 90 Deg Last Block

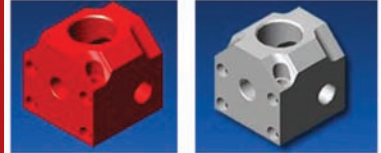

First Block

Last Block



Mod Block

Mid/End Block

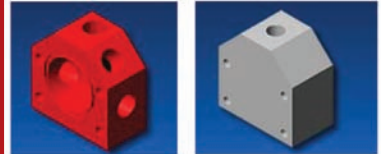

O-Ring

Tie Rod



Assembly includes o-rings and hardware required for each block.

90 Deg First Block

Part Number	Outlet Size	Color
FB2-FB90-1-4-R	1/4"	Red
FB2-FB90-1-4-B	1/4"	Blue
FB2-FB90-1-6-R	3/8"	Red
FB2-FB90-1-6-B	3/8"	Blue

90 Deg Last Block

Part Number	Outlet Size	Color
FB2-FB90-1-4-CL	1/4"	Clear
FB2-FB90-1-6-CL	3/8"	Clear

First Block

Part Number	Outlet Size	Color
FB2-FB-1-4-R	1/4"	Red
FB2-FB-1-4-B	1/4"	Blue
FB2-FB-1-6-R	3/8"	Red
FB2-FB-1-6-B	3/8"	Blue

Mod Block

Part Number	Outlet Size	Color
FB2-MOD-4-R	1/4"	Red
FB2-MOD-4-B	1/4"	Blue
FB2-MOD-6-R	3/8"	Red
FB2-MOD-6-B	3/8"	Blue

Last Block (Port-to-Port only)

Part Number	Outlet Size	Color
FB2-LB-1-4-CL	1/4"	Clear
FB2-LB-1-6-CL	3/8"	Clear

Mid/End Block

Part Number	Outlet Size	Color
FB2-EB-1-CL	n/a	Clear



FB3 90 Degree Series

Specifications

Block Size: 3.00" W x 3.00" H
 Material: 6061-T6, Anodized
 Mounting Hole Size: 3/8" SHCS
 Inlet Hole: 1-1/2" NPT
 Outlet Hole: 3/8" or 1/2"
 (5) Outlet Holes per Standard Block
 (3) Outlet Holes per 90 Degree Block

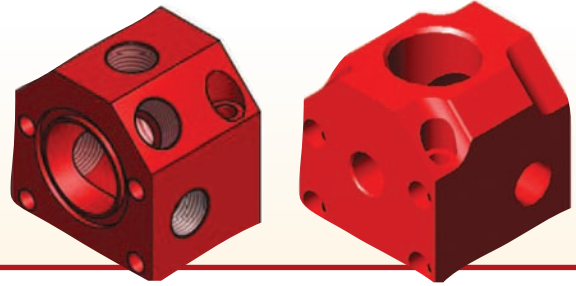

Port-to-Divide (PD)

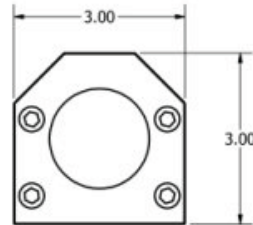
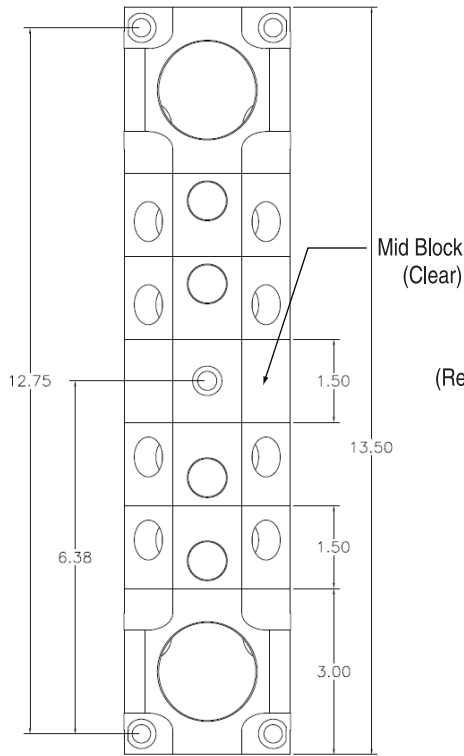

Port-to-Port (PP)

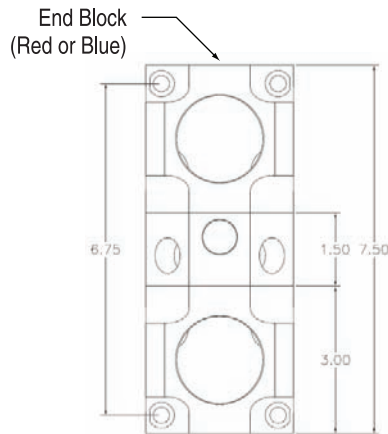

Port-to-Blank (PB)

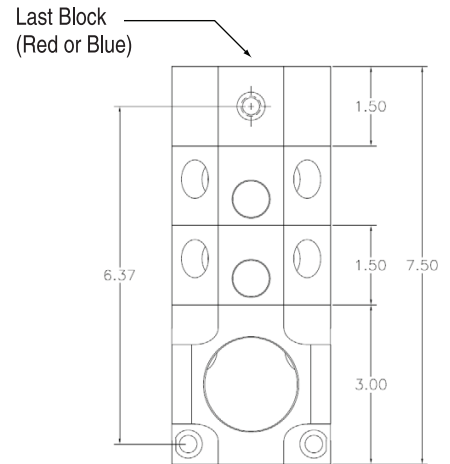

Port-to-Divide



Port-to-Port



Port-to-Blank



3/8" Outlet
 Assembly No.
 FB390-1-6-PD
 FB390-2-6-PD
 FB390-3-6-PD
 FB390-4-6-PD
 FB390-5-6-PD

1/2" Outlet
 Assembly No.
 FB390-1-8-PD
 FB390-2-8-PD
 FB390-3-8-PD
 FB390-4-8-PD
 FB390-5-8-PD

3/8" Outlet, Red
 Assembly No.
 FB390-2-6-R-PP
 FB390-3-6-R-PP
 FB390-4-6-R-PP
 FB390-5-6-R-PP
3/8" Outlet, Blue
 Assembly No.
 FB390-2-6-B-PP
 FB390-3-6-B-PP
 FB390-4-6-B-PP
 FB390-5-6-B-PP

1/2" Outlet, Red
 Assembly No.
 FB390-2-8-R-PP
 FB390-3-8-R-PP
 FB390-4-8-R-PP
 FB390-5-8-R-PP
1/2" Outlet, Blue
 Assembly No.
 FB390-2-8-B-PP
 FB390-3-8-B-PP
 FB390-4-8-B-PP
 FB390-5-8-B-PP

3/8" Outlet, Red
 Assembly No.
 FB390-1-6-R-PB
 FB390-2-6-R-PB
 FB390-3-6-R-PB
 FB390-4-6-R-PB
 FB390-5-6-R-PB
3/8" Outlet, Blue
 Assembly No.
 FB390-1-6-B-PB
 FB390-2-6-B-PB
 FB390-3-6-B-PB
 FB390-4-6-B-PB
 FB390-5-6-B-PB

1/2" Outlet, Red
 Assembly No.
 FB390-1-8-R-PB
 FB390-2-8-R-PB
 FB390-3-8-R-PB
 FB390-4-8-R-PB
 FB390-5-8-R-PB
1/2" Outlet, Blue
 Assembly No.
 FB390-1-8-B-PB
 FB390-2-8-B-PB
 FB390-3-8-B-PB
 FB390-4-8-B-PB
 FB390-5-8-B-PB

FB3 Series Manifold

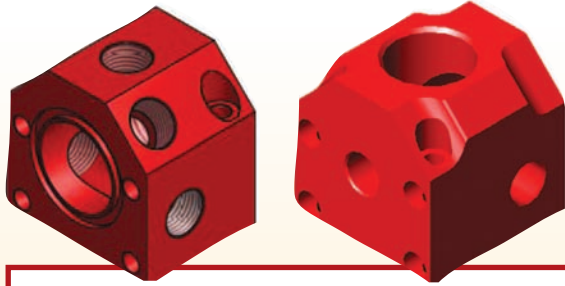

Specifications

Block Size: 3.00" W x 3.00" H
 Material: 6061-T6, Anodized
 Mounting Hole Size: 3/8" SHCS
 Inlet Hole: 1-1/2" NPT
 Outlet Hole: 3/8" or 1/2"
 (5) Outlet Holes per Standard Block
 (3) Outlet Holes per 90 Degree Block

Port-to-Port (PP)

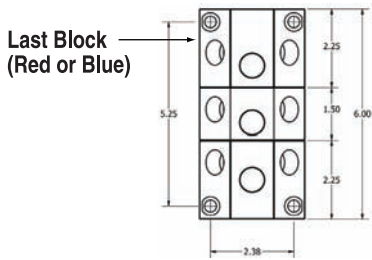

Port-to-Blank (PB)

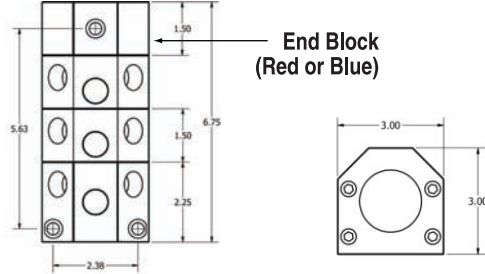

Port-to-Divide (PD)

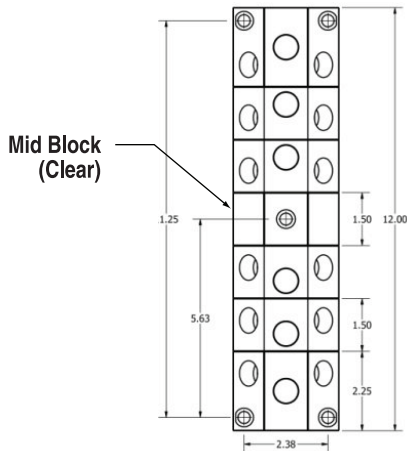

Port-to-Divide



3/8" Outlet

Assembly No.

FB3-1-6-PD
 FB3-2-6-PD
 FB3-3-6-PD
 FB3-4-6-PD
 FB3-5-6-PD

1/2" Outlet

Assembly No.

FB3-1-8-PD
 FB3-2-8-PD
 FB3-3-8-PD
 FB3-4-8-PD
 FB3-5-8-PD

Port-to-Port



3/8" Outlet, Red

Assembly No.

FB3-2-6-R-PP
 FB3-3-6-R-PP
 FB3-4-6-R-PP
 FB3-5-6-R-PP

1/2" Outlet, Red

Assembly No.

FB3-2-8-R-PP
 FB3-3-8-R-PP
 FB3-4-8-R-PP
 FB3-5-8-R-PP

3/8" Outlet, Blue

Assembly No.

FB3-2-6-B-PP
 FB3-3-6-B-PP
 FB3-4-6-B-PP
 FB3-5-6-B-PP

1/2" Outlet, Blue

Assembly No.

FB3-2-8-B-PP
 FB3-3-8-B-PP
 FB3-4-8-B-PP
 FB3-5-8-B-PP

Port-to-Blank



3/8" Outlet, Red

Assembly No.

FB3-1-6-R-PB
 FB3-2-6-R-PB
 FB3-3-6-R-PB
 FB3-4-6-R-PB
 FB3-5-6-R-PB

1/2" Outlet, Red

Assembly No.

FB3-1-8-R-PB
 FB3-2-8-R-PB
 FB3-3-8-R-PB
 FB3-4-8-R-PB
 FB3-5-8-R-PB

3/8" Outlet, Blue

Assembly No.

FB3-1-6-B-PB
 FB3-2-6-B-PB
 FB3-3-6-B-PB
 FB3-4-6-B-PB
 FB3-5-6-B-PB

1/2" Outlet, Blue

Assembly No.

FB3-1-8-B-PB
 FB3-2-8-B-PB
 FB3-3-8-B-PB
 FB3-4-8-B-PB
 FB3-5-8-B-PB

90 Deg First Block



First Block



Last Block



Mod Block



Mid/End Block



O-Ring

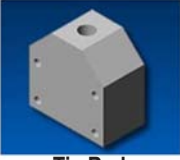

Tie Rod

Assembly includes o-rings and hardware required for each block.

90 Deg First Block

Part Number	Outlet Size	Color
FB3-FB90-1.5-6-R	3/8"	Red
FB3-FB90-1.5-6-B	3/8"	Blue
FB3-FB90-1.5-8-R	1/2"	Red
FB3-FB90-1.5-8-B	1/2"	Blue

90 Deg Last Block

Part Number	Outlet Size	Color
FB3-FB90-1.5-6-CL	3/8"	Clear
FB3-FB90-1.5-8-CL	1/2"	Clear

First Block

Part Number	Outlet Size	Color
FB3-FB-1.5-6-R	3/8"	Red
FB3-FB-1.5-6-B	3/8"	Blue
FB3-FB-1.5-8-R	1/2"	Red
FB3-FB-1.5-8-B	1/2"	Blue

Mod Block

Part Number	Outlet Size	Color
FB3-MOD-6-R	3/8"	Red
FB3-MOD-6-B	3/8"	Blue
FB3-MOD-8-R	1/2"	Red
FB3-MOD-8-B	1/2"	Blue

Last Block (Port-to-Port only)

Part Number	Outlet Size	Color
FB3-LB-1.5-6-CL	3/8"	Clear
FB3-LB-1.5-8-CL	1/2"	Clear

Mid/End Block

Part Number	Outlet Size	Color
FB3-EB-1.5-CL	n/a	Clear



FB2 90 Degree Series

Specifications

Block Size: 2.25" W x 2.25" H
 Material: 6061-T6, Anodized
 Mounting Hole Size: 1/4" SHCS
 Inlet Hole: 1" NPT
 Outlet Hole: 1/4" or 3/8"
 (5) Outlet Holes per Standard Block
 (3) Outlet Holes per 90 Degree Block

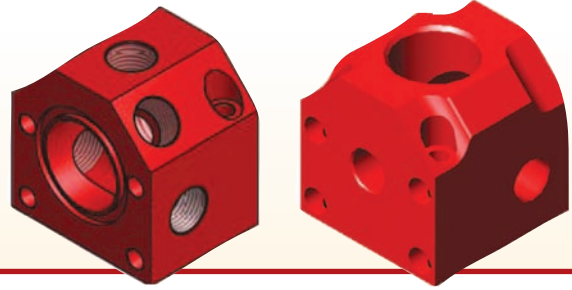

Port-to-Divide (PD)

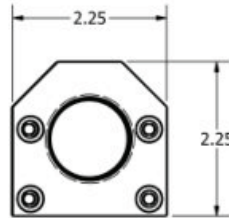
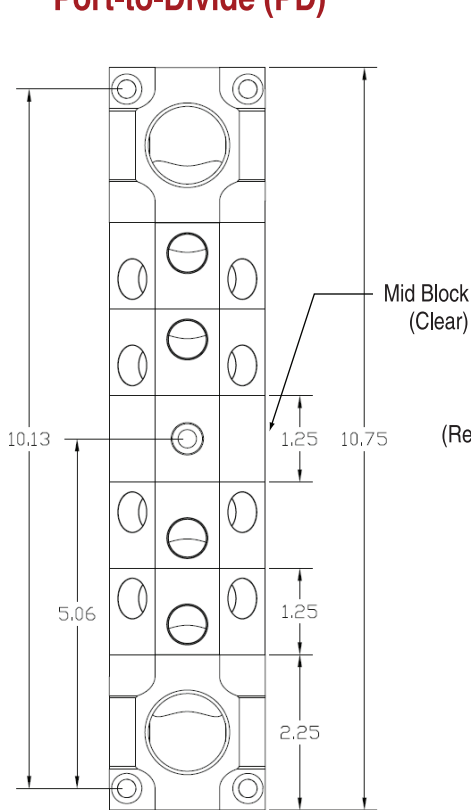

Port-to-Port (PP)

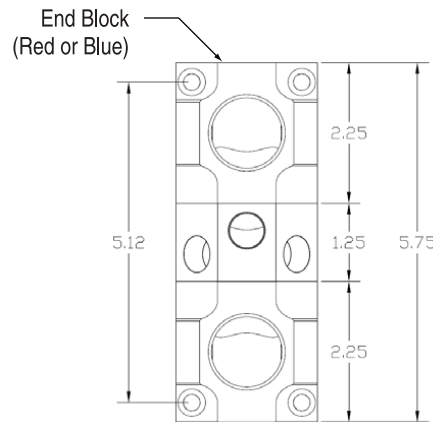

Port-to-Blank (PB)

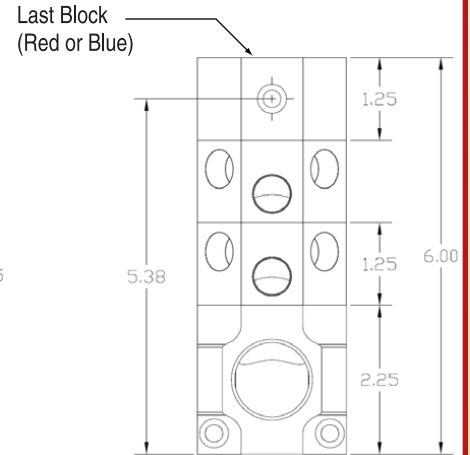

Port-to-Divide

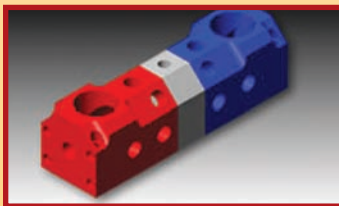

Port-to-Port



Port-to-Blank



1/4" Outlet Assembly No.	3/8" Outlet Assembly No.
FB290-1-4-PD	FB290-1-6-PD
FB290-2-4-PD	FB290-2-6-PD
FB290-3-4-PD	FB290-3-6-PD
FB290-4-4-PD	FB290-4-6-PD
FB290-5-4-PD	FB290-5-6-PD

1/4" Outlet, Red Assembly No.	3/8" Outlet, Red Assembly No.
FB290-2-4-R-PP	FB290-2-6-R-PP
FB290-3-4-R-PP	FB290-3-6-R-PP
FB290-4-4-R-PP	FB290-4-6-R-PP
FB290-5-4-R-PP	FB290-5-6-R-PP
1/4" Outlet, Blue Assembly No.	3/8" Outlet, Blue Assembly No.
FB290-2-4-B-PP	FB290-2-6-B-PP
FB290-3-4-B-PP	FB290-3-6-B-PP
FB290-4-4-B-PP	FB290-4-6-B-PP
FB290-5-4-B-PP	FB290-5-6-B-PP

1/4" Outlet, Red Assembly No.	3/8" Outlet, Red Assembly No.
FB290-1-4-R-PB	FB290-1-6-R-PB
FB290-2-4-R-PB	FB290-2-6-R-PB
FB290-3-4-R-PB	FB290-3-6-R-PB
FB290-4-4-R-PB	FB290-4-6-R-PB
FB290-5-4-R-PB	FB290-5-6-R-PB
1/4" Outlet, Blue Assembly No.	3/8" Outlet, Blue Assembly No.
FB290-1-4-B-PB	FB290-1-6-B-PB
FB290-2-4-B-PB	FB290-2-6-B-PB
FB290-3-4-B-PB	FB290-3-6-B-PB
FB290-4-4-B-PB	FB290-4-6-B-PB
FB290-5-4-B-PB	FB290-5-6-B-PB